

GSM Commander: Irrigation Control & Monitoring



Farm Irrigation

Use the GSM Commander to control pumps, booster pumps and centre Pivots.

Scenario & Application

A farmer wants to irrigate only during **GREEN** time to save on costs. A GSM Commander is installed at the pump house inside an enclosure with back up battery.



Commands for Control & Monitoring

- monitor if ground is moist
- automatically turn on irrigation during set time
- monitor outdoor temperature
- monitor if pumps & booster pumps have come on
- alert if faults occur (pumps not working correctly)
- Cable theft on all cables
- GSM Commander can notify the relevant people if Pump has switched on/off
- GSM Commander can notify if the pumps temperature exceeds the normal temp.

Each application has different requirements and the commander can be configured to your needs.

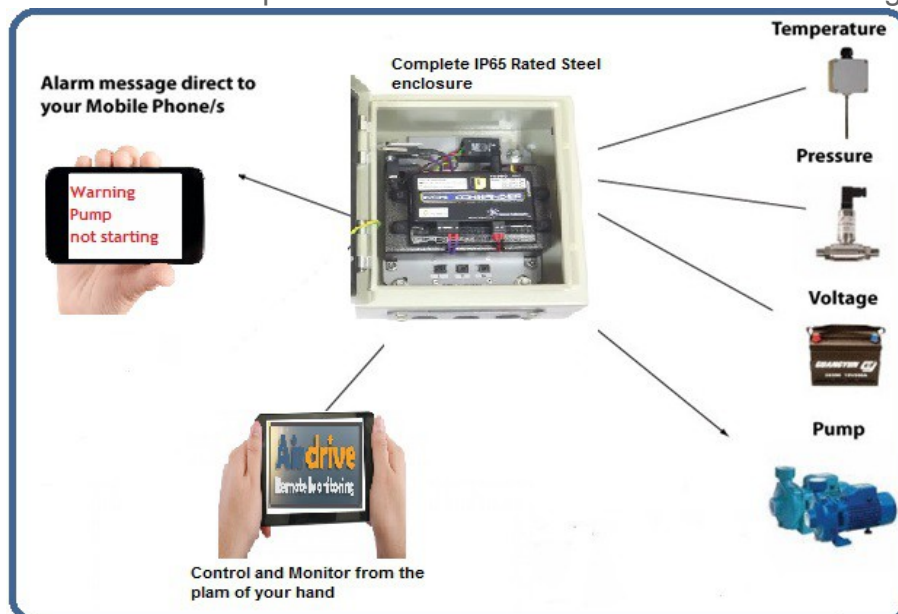

Golf Course Management

Use the GSM Commander to control your irrigation system and prohibit access.

Scenario & Application

A golf course wants to be able to control who enters their property to stop unauthorized access from non-members and to control the entire irrigation system.

A GSM Commander is connected to the main gate motor, read switch at the gate and the irrigation control box, together with a 12V back-up battery, moisture sensor and temperature probe.



Commands for Control & Monitoring

With a few additional accessories you can do the following:

- Monitor whether it's rained or not
- Automatically turn on irrigation system on and off when it hasn't rained
- monitor outdoor temperature
- automatically turn on irrigation at night for slightly longer on the hotter days.
- Send sms to add and remove cellphone numbers from the GSM commander
- Open a gate if missed call (drop) is received (only if cellphone number is in the list)
- GSM Commander sends sms to you if either gate remains open for longer than 60sec.
- GSM Commander sends SMS to you if either gate is forcefully opened
- GSM Commander sends SMS to you when mains power fails
- GSM Commander sends sms to you when battery voltage goes below 10.5V

Estate Irrigation Control

Use the GSM Commander to control your irrigation system

Scenario & Application

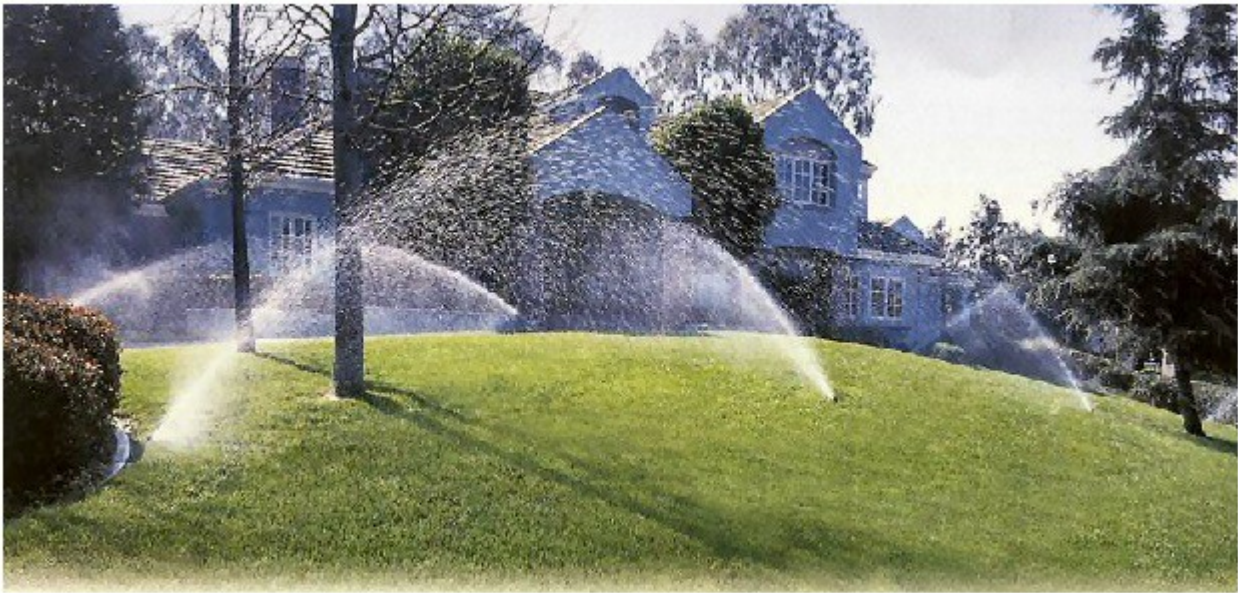

An estate wants to be able to automatically control their entire irrigation system. A GSM commander is connected to the irrigation control box together with a 12V back up battery, moisture sensor and temperature probe.

Commands for Control & Monitoring

With a few additional accessories you can do the following:

- Monitor whether it's rained or not
- Automatically turn on irrigation system on and off when it hasn't rained
- monitor outdoor temperature
- automatically turn on irrigation at night for slightly longer on the hotter days.
- GSM Commander sends SMS to you when mains power fails
- GSM Commander sends sms to you when battery voltage goes below 10.5V

